



Norimaki Maker for Commercial Use

MAKI MAKER ASA190A

Operation Manual

Thank you for purchasing the MAKI MAKER ASA190A.

- Before using this machine, please read this operation manual for instructions and to learn about proper operation.
- This machine is for making norimaki only. Do not use it for any other purpose.
- This machine should be used under the supervision and instruction of a person who has sufficiently understood its functions and operation procedure. Improper use may result in injury, machine failure, or breakage.
- For future reference, keep this manual in a handy location with the warranty.

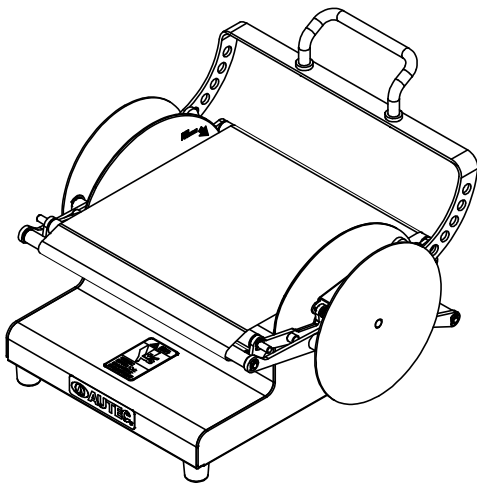



Table of Contents	Page
Safety Precautions	1
Name of Each Component and Consumable Parts List	5
Preparations Before Use	7
How to Attach the Parts	8
How to Detach Parts	10
How to Clean Each Component	11
Operating Instructions	13
Troubleshooting Checklist	17
Recommended Inspections	17
Warranty & Repairs	18
Product Specifications	19
External Diagrams	20

Accessory List	
1. Push Shaft	2
2. Belt	1
3. Safety Cover	2
4. Operation Manual (This Book)	1
5. Warranty Card	1





Safety Precautions (Read this instruction before using.)

To prevent harm to the user and others as well as damage to property, the following instructions must be observed.

- The kinds of harm or damage that may arise due to failure to observe these instructions and due to improper use are identified by the following labels according to their severity.

 WARNING	Improper handling may cause death or serious injury to the operator.
 CAUTION	Improper handling may cause injury to the operator or damage to property.

- Cautions that must be observed are identified by the following symbols.

 This symbol indicates the need for attention. The caution is indicated within or near the symbol.	 General precaution	
 This symbol indicates a prohibited action. The prohibited action is indicated within or near the symbol.	 Do not touch	 Do not disassemble

WARNING

■ Installation

This machine weighs about 15.4 lbs. (7 kg). Place it on a flat, stable surface. During installation, do not apply any shock to the machine.

Use this machine in a location with an ambient temperature between 32°F and 104°F (0°C and 40°C) that has a humidity of 85% or less and where there is no frost or condensation. Do not install the machine in a location that is exposed to fire, corrosive gases, direct sunlight, dust, or strong vibration.

■ Use and handling

Do not touch the moving parts.

Never touch or put your hands or chopsticks into the moving parts during operation.



Do not disassemble!

Never disassemble or modify the main unit (except to detach washable parts).

If you disassemble or modify the machine, a fee will be charged for repairs even if the product is within the warranty period.



Be careful when carrying it!

When carrying the machine, set the **Handle** to the open position, firmly hold the front and rear parts of the main unit with both hands, and carry the machine while keeping it in a horizontal position. Carrying the machine while holding the **Handle** or other parts may cause an injury or failure.

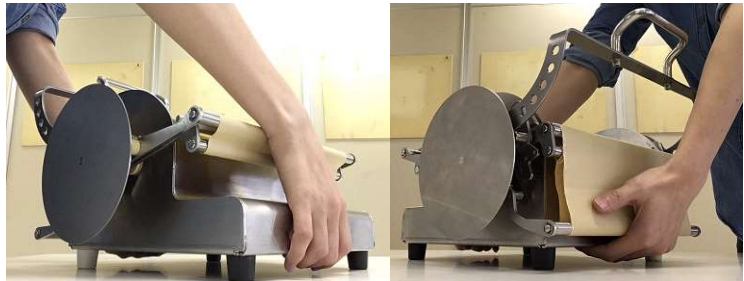

Do not deform the main unit or parts.

The shapes of the main unit and parts can change easily if they are dropped or bumped. Deformation of the main unit or parts may lead to faulty forming or failure. **Handle** the main unit and parts with care.

CAUTION

■ Use and handling

Do not push down the Handle too strongly.

When a strong force (e.g., body weight) is applied to the **handle** in a downward direction from the closed position during the norimaki forming operation, the main unit may roll over, causing injury or failure.

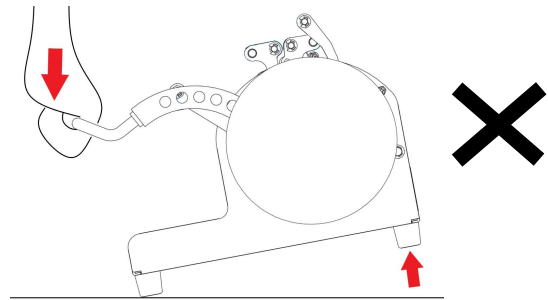

Be careful when attaching or detaching the Safety Cover.

Pay sufficient attention when attaching or detaching the **Safety Cover**. If hands touch the edges of other parts, injury may result.

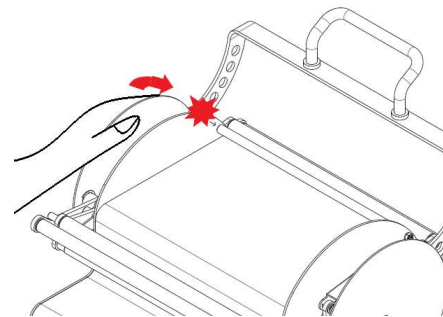

Be sure to attach the Safety Cover.

Operating the machine without attaching the **Safety Cover** is very dangerous. Such operation may cause injury or damage the machine.

Do not operate the Handle while the Belt is empty.

Pressing down the **Handle** while the **Belt** is empty may make a crease, weakening the **Belt**.

Do not hold parts other than the Handle while operating the machine.

Be sure to hold the **Handle** while operating the machine. Operating the machine by holding parts other than the **Handle** may cause injury or damage.

■ How to clean

Use a sponge to wash the Belt.

Use only a soft sponge to wash the **Belt**. Never use a scrub brush. Scratches to the parts may inhibit the forming function.

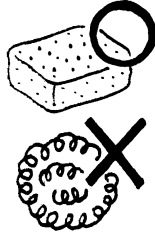

Use only a neutral detergent.

Only use a neutral detergent. Some detergents may cause the parts to deteriorate and inhibit the forming function.



Do not use hot water for washing.

Never wash the main unit or individual components with hot water or in an automatic dishwasher. Doing so may cause the main unit to deform or deteriorate or inhibit the forming function.
(Allowable temperature: Up to 158°F (70°C))

Pay attention when using a disinfectant.

Be sure to follow the precautions and instructions when using a disinfectant (e.g., chlorine-type sterilizing agent). Observe the suggested concentration, properly ventilate, and sufficiently rinse in water after use. Extensive soaking or an excessive concentration may cause deterioration or inhibit the forming function.
If the parts deteriorate or the function is inhibited due to a failure to observe these precautions, a fee will be charged for repairs even if the product is within the warranty period.

Do not expose the belt to UV light.

Do not expose the **belt** to direct sunlight or UV light in order to sterilize it. Doing so may cause discoloration or deterioration of the **belt**.

Apply grease to the specified areas.

Regularly apply grease to the specified areas. Insufficient grease may cause a failure. (Refer to p.12.)

Do not wash the specified areas and parts.

Do not wash the specified areas and parts. Doing so may cause a failure. (Refer to pp. 11 and 12.)

Name of Each Component and Consumable Parts List

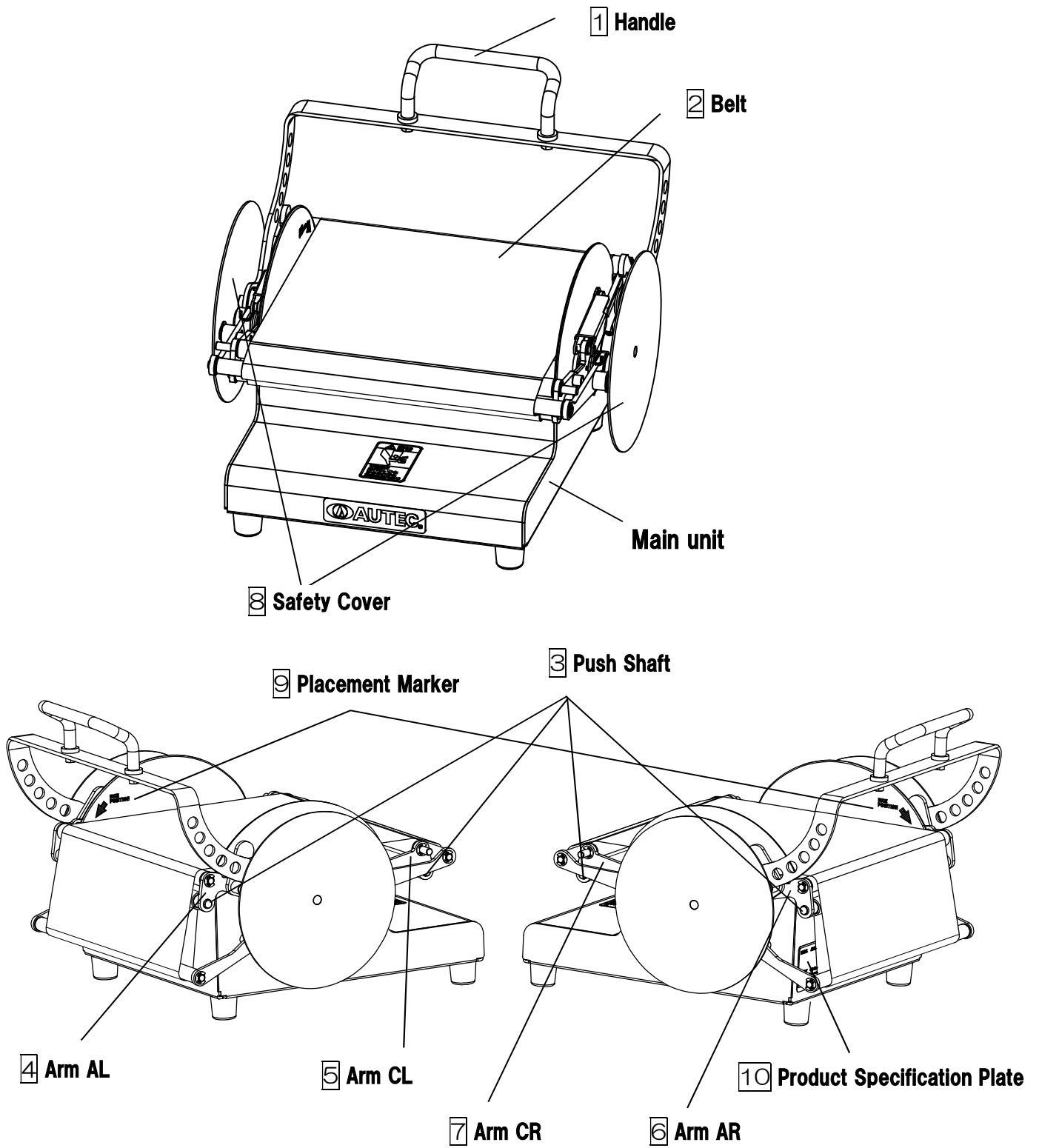

Name of Each Component

No.	Name	Purpose
1	Handle	By holding and moving the Handle , the arms can be moved to form norimaki.
2	Belt	A belt for wrapping and rolling the rice mat and ingredients to form norimaki.
3	Push Shaft	Passes through the Belt for securing to the main unit.
4	Arm AL	An arm to attach to the Push Shaft (left rear of the main unit).
5	Arm CL	An arm to attach to the Push Shaft (front left of the main unit).
6	Arm AR	An arm to attach to the Push Shaft (rear right of the main unit).
7	Arm CR	An arm to attach to the Push Shaft (front right of the main unit).
8	Safety Cover	A cover for the mechanical sections.
9	Placement Marker	Markers that indicate the positions to place the rice mat on the Belt .
10	Product Specification Plate	Indicates part numbers, the mass, serial number, and other information related to the product specifications.

Consumable Parts List

No.	Name	Purpose
2	Belt	A belt for wrapping and rolling the rice mat and ingredients to form norimaki.
3	Push Shaft	Passes through the Belt for securing to the main unit.

Preparations Before Use

1. Attach the Safety Cover (included as an accessory).

Note: Carefully read "Use and Handling" (p. 3) before attaching the parts.

Secure the thread part located in the center of the **Safety Cover** in the threaded hole (Handle support part) on the main unit. In the same way, attach the **Safety Cover** on the opposite side.

* When securing the part, hold and secure the **Handle**.

* Pay sufficient attention when attaching the **Safety Cover**. If hands touch the edges of other parts, injury may result.

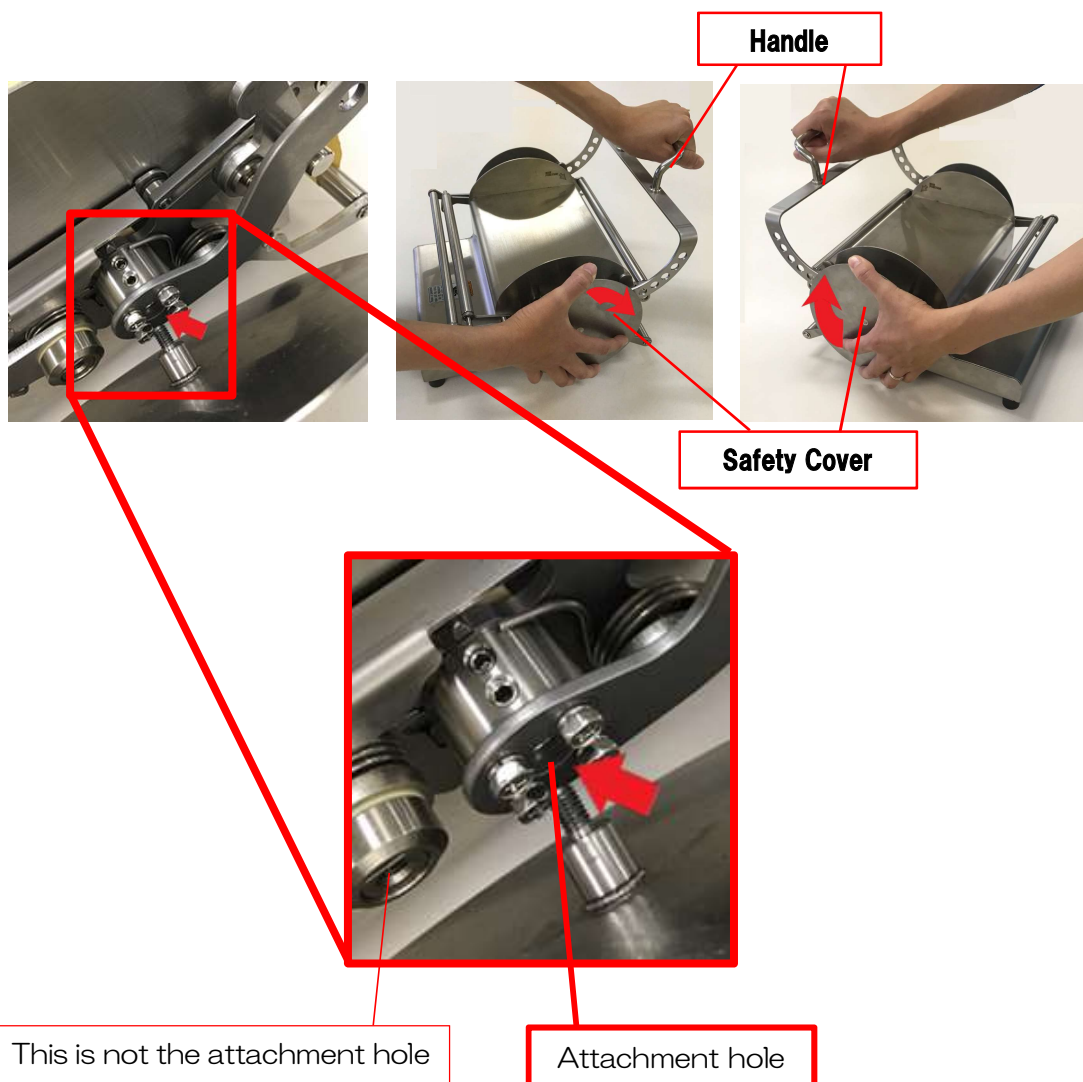

How to Attach the Parts

1. How to Attach the Belt

1-1

Confirm whether you are looking at the front or back surface of the **Belt**.

* There is no difference in terms of material quality between the front and back surfaces.

The side with the joint is the back surface of the **Belt**.

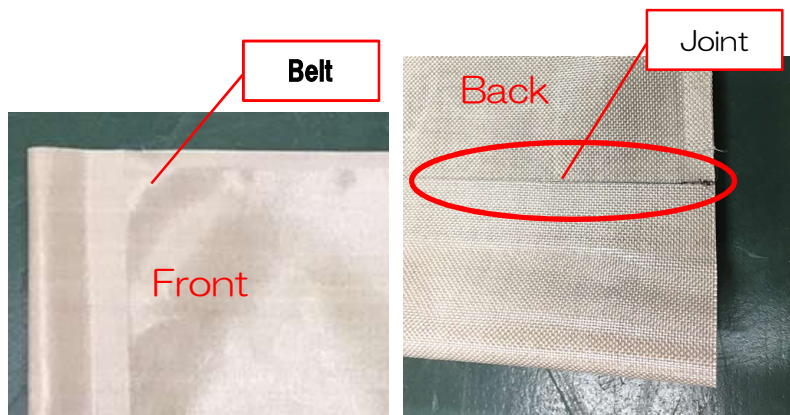

1-2

Insert the **Push Shafts** into the two through holes on both ends of the **Belt**.

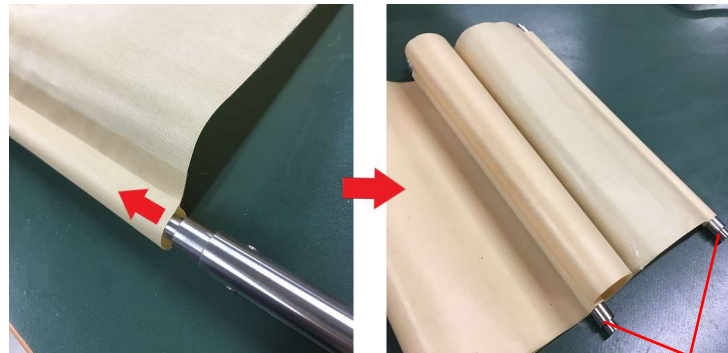

Push Shafts

1-3

Place the **Belt** so that the front surface faces upward. Bring one of the **Push Shafts** to the front of the main unit.

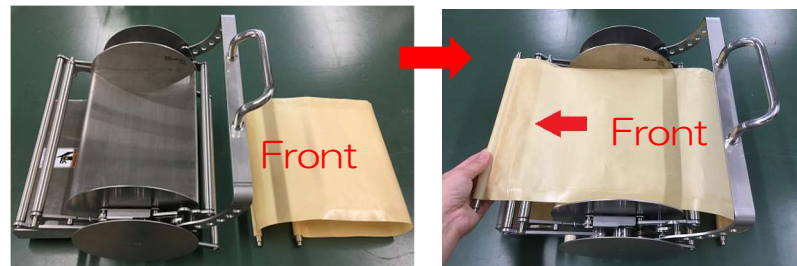

1-4

Insert the **Push Shaft** in the hole of the **Arm CL** located on the front left of the main unit. Insert one end of the **Push Shaft** into the hole.

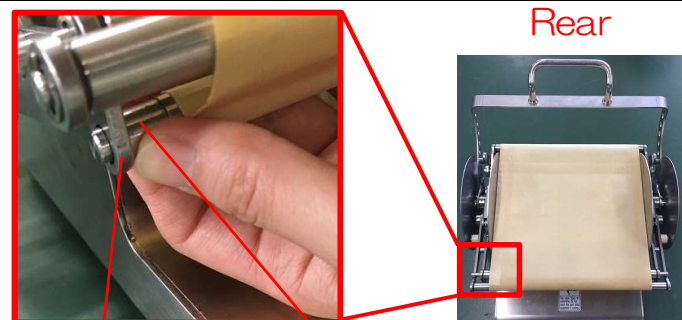

Arm CL

Push Shaft

Front

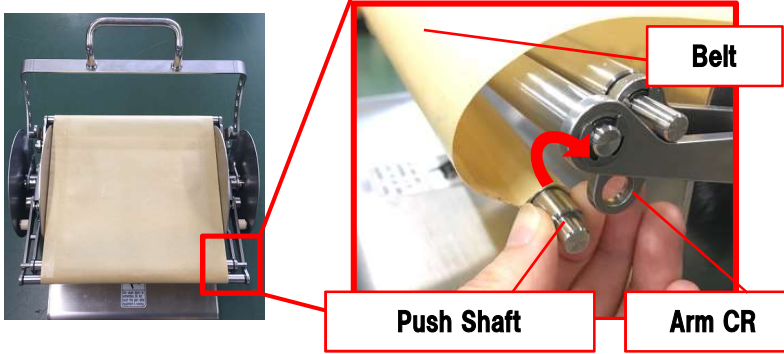
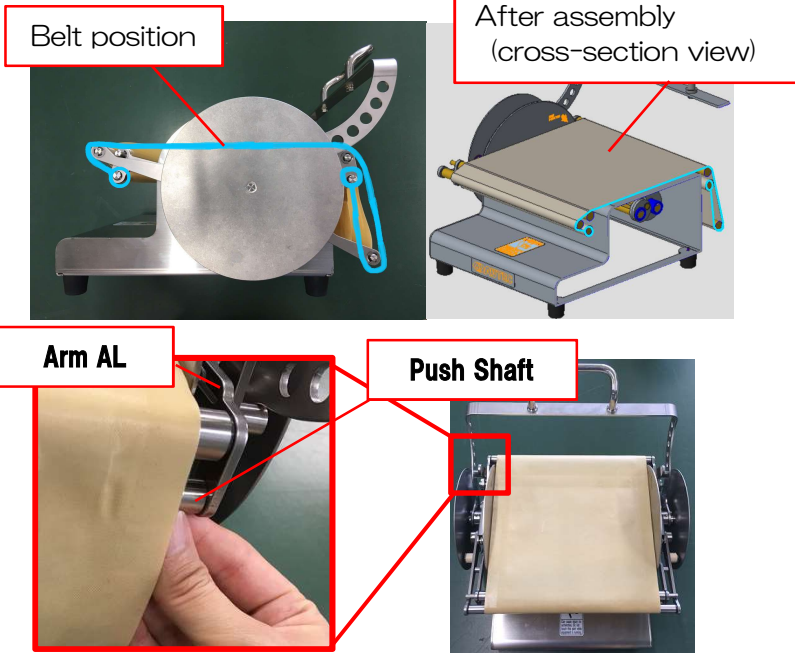
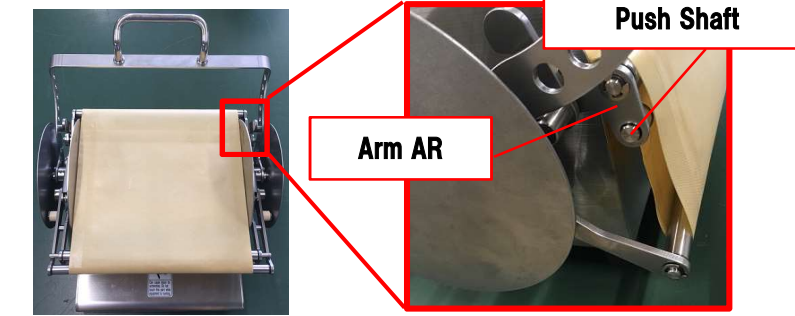
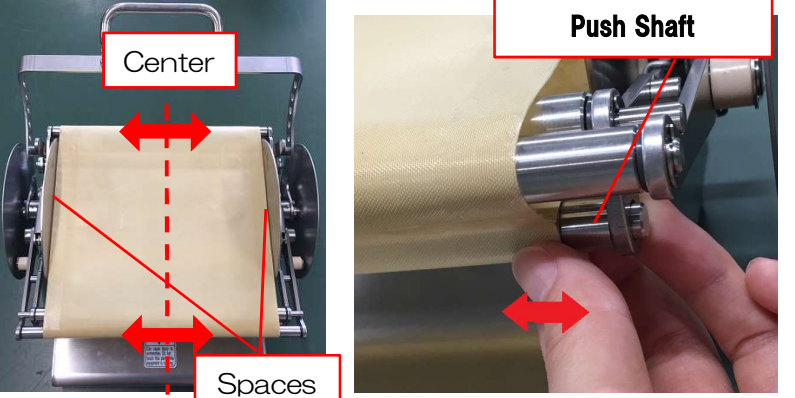
<p>1-5 Insert the other end of the Push Shaft into the hole of the Arm CR located on the front right of the main unit. At this time, push the Push Shaft in the insertion direction to contract the length and set it in the Arm CR.</p>	
<p>1-6 Position the Belt as shown in the figure and insert one end of the Push Shaft into the hole of the Arm AL located on the rear left of the main unit.</p>	
<p>1-7 Insert the other end of the Push Shaft into the hole of the Arm AR located on the rear right of the main unit. At this time, push the Push Shaft in the insertion direction to contract the length and set it in the Arm AR.</p>	
<p>1-8 Position the Belt at the center of the main unit. At this time, adjust the position of the Belt so that the main unit is evenly spaced between the right and left sides of the Belt.</p>	

How to Detach the Parts

Detach parts in the opposite sequence described in “Preparations Before Use” (p. 7) and “How to Attach the Parts” (pp. 8 and 9).

1. How to Detach the Belt

Remove the two **Push Shafts** from the arms in the front and rear of the main unit.
Detach the **Belt** from the main unit.

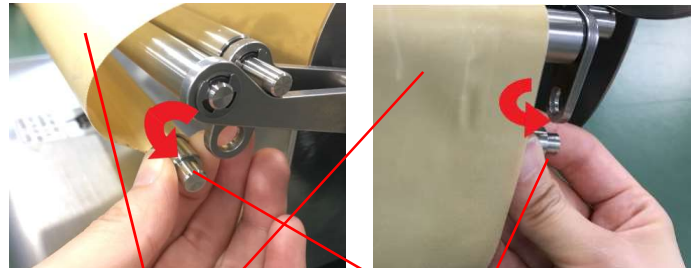

Belt

Push Shafts

2. How to Detach the Safety Cover

Rotate the **Safety Cover** to detach it from the main unit. At this time, pay sufficient attention because if hands touch the edges of other parts, injury may result.

* Hold the **Handle** to prevent it from moving along with the **Safety Cover**.

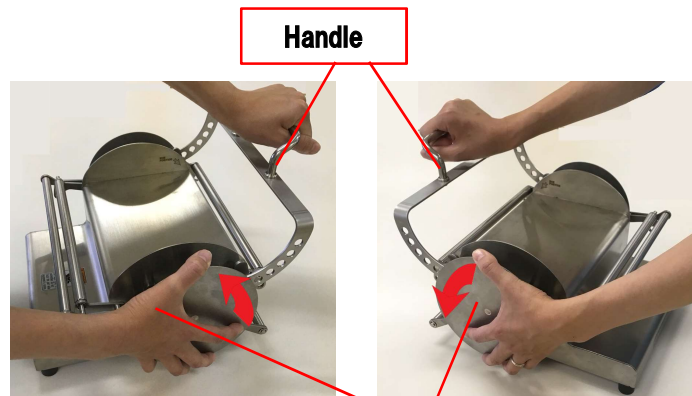

Handle

Safety Cover

How to Clean Each Component

To clean each component, follow the instructions below.

Note: Carefully read the “Safety Precautions” (pp. 1 to 4) before washing or cleaning the components.

Remove any moisture from washed parts and the main unit after cleaning. Give them sufficient time to dry at ambient temperature.

1. <Main Unit>

1-1 External Parts of the Main Unit

For the areas indicated in red in the figure below, wipe them with a moistened cloth to clean them and remove any stains or oil.

* Never wash the main unit.

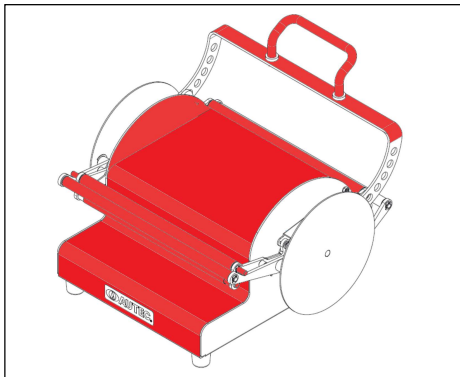

1-2 Right and Left Structural Sections of the Main Unit

For the areas indicated in red in the figure below, clean them with an implement (e.g., brush) and remove any food scraps or other materials.

* Never wash the structural sections of the main unit.

* Never move the **Handle** while cleaning the machine.

Do not touch the structural sections directly with the hand because it is dangerous.

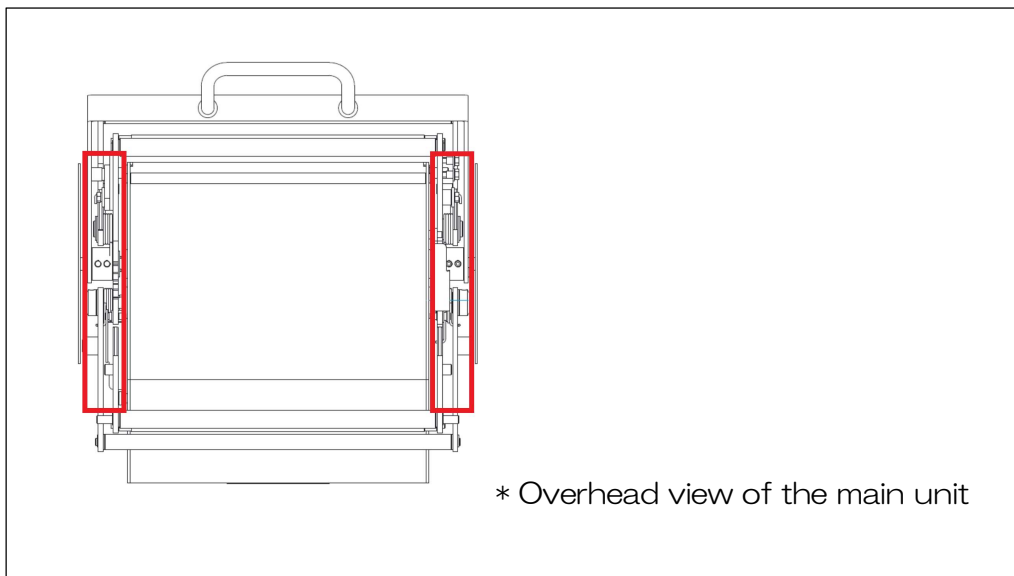

1-3 Mechanical Section of the Main Unit

Regularly apply grease to the areas indicated in red in the figure below (* use only grease that can unintentionally come into contact with food).

- * Never wash the mechanical sections of the main unit.
- * Do not touch the mechanical sections directly with the hand because it is dangerous.
- * Using the machine without applying grease for a long period may cause a failure.

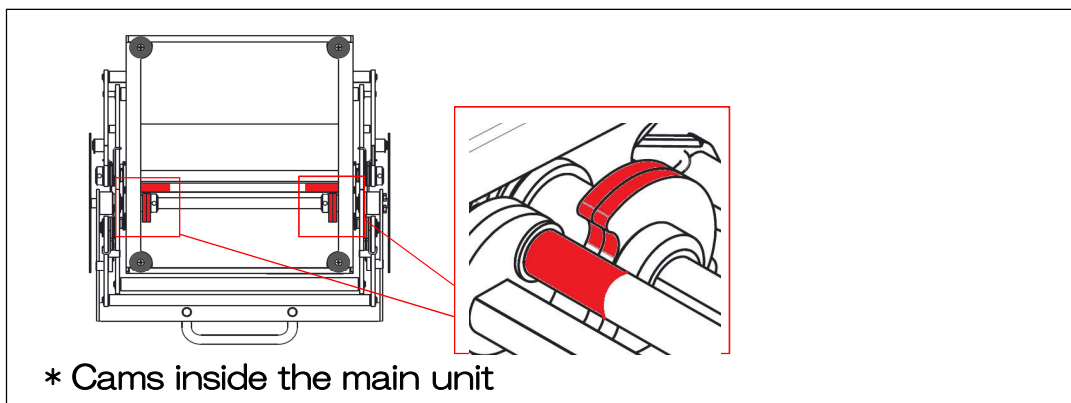
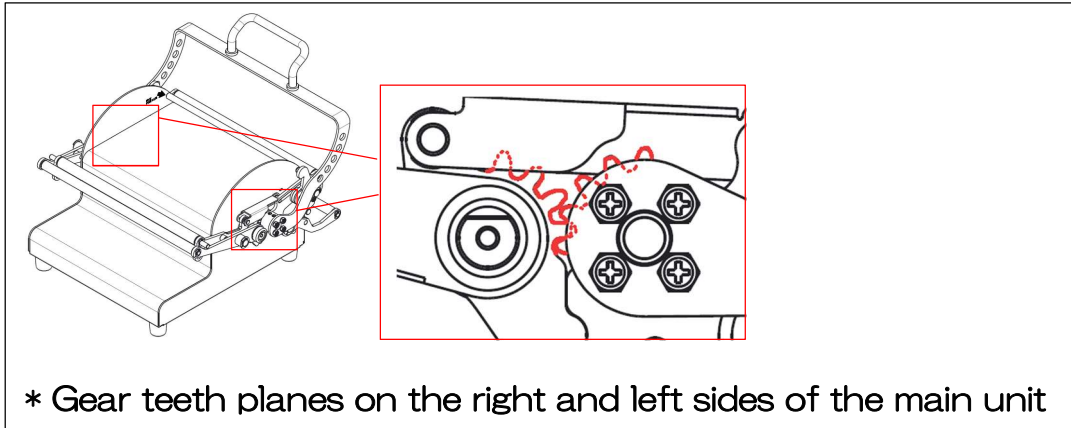

2. <Parts>

2-1 Safety Cover

Soak the Safety Cover in lukewarm water with a neutral detergent to wash it and remove any stains or oil.

Remove any moisture and give it sufficient time to dry at ambient temperature.

2-2 Belt

Foam the neutral detergent with a soft sponge and use the sponge to remove any stains from the surface. Then, sufficiently rinse the **Belt** with water.

Remove any moisture and give it sufficient time to dry at ambient temperature.

2-3 Push Shafts

Wipe the **Push Shafts** with a moistened cloth to clean them and remove any stains or oil.

- * Never wash the **push shafts**.

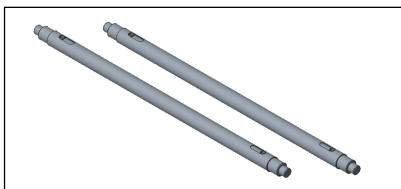

Operating Instructions





1. Properly attach the parts.

Attach the parts in accordance with “Preparations Before Use” (p. 7) and “How to Attach the Parts” (pp. 8 and 9).

Note: Sufficiently check that the parts have been properly attached. Inappropriate attachment of parts may cause damage to or failure of the parts.

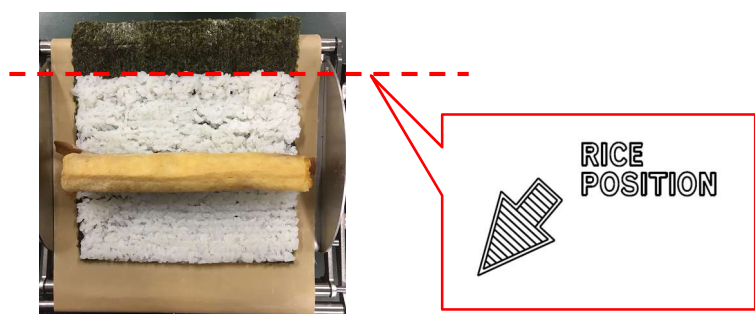
2. Form norimaki by following the operation procedure below.

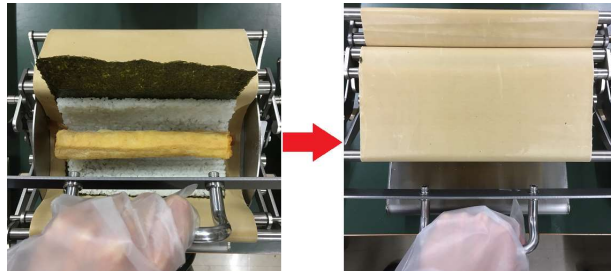
This section describes patterns for four types of rolls. Select the forming method according to the intended purpose.

Regular Roll [Pattern A]	
<p>(1) Place the rice mat with dried laver seaweed attached and ingredients on the Belt.</p> <p>* As for the position, place the back of the rice mat on the RICE POSITION ↘ marker.</p>	
<p>(2) Adjust the ingredients to fit exactly one rolling of the rice mat.</p> <p>* Noticeable wrinkles may appear on the dried laver seaweed depending on the ingredients and how they are adjusted.</p>	
<p>(3) Fully pull the Handle and hold it in place for about 3 seconds.</p> <p>* Do not pull down the Handle excessively. Doing so may cause the main unit to roll over and damage it.</p>	
<p>(4) Gradually return the Handle to its original position and remove the completed norimaki.</p>	 <p>* Image after cutting the completed norimaki</p>

Regular Roll [Pattern B]

(1) Place the rice mat and ingredients on the **Belt** and slide 3-10mm of the seaweed edge under the rice mat.

*Adjust the rice mat length shorter than that of seaweed to have the overlapping section.

* As for the position, place the back of the rice mat on the

RICE POSITION ↘
marker.



RICE
POSITION

(2) Fully pull the **Handle** and hold it in place for about 3 seconds.

* Do not pull down the **Handle** excessively. Doing so may cause the main unit to roll over and damage it.

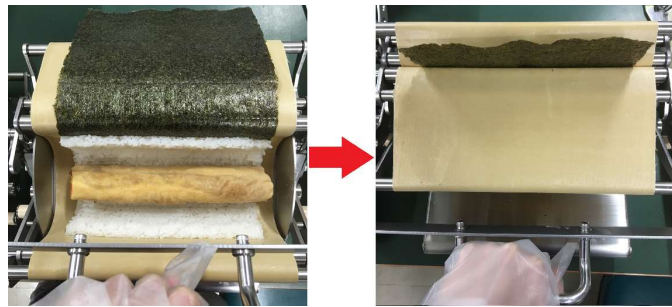

(3) Gradually return the **Handle** to its original position, remove the norimaki, and wrap the overlapping section.



* Image after cutting the completed norimaki

Inside-out Roll [Pattern A]

(1) Place the rice mat with dried laver seaweed attached and ingredients on the **Belt**.
Adjust the ingredients to fit exactly one rolling of the rice mat.
* The roll may be formed loose due to gaps between the ingredients and dried laver seaweed depending on the ingredients and how they are adjusted.

* As for the position, place the back of the rice mat on the RICE POSITION ↘ marker.



(2) Fully pull the **Handle** and hold it in place for about 3 seconds.

* Do not pull down the **Handle** excessively. Doing so may cause the main unit to roll over and damage it.

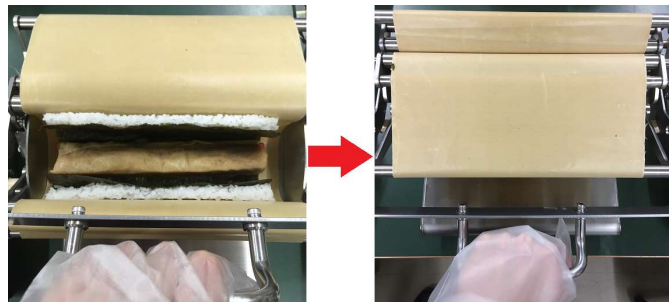

(3) Gradually return the **Handle** to its original position and remove the completed norimaki.



* Image after cutting the completed norimaki

Inside-out Roll [Pattern B]

(1) Place the rice mat with dried laver seaweed attached and ingredients on the **Belt**.
* Adjust it so that the rice sticks out slightly beyond the upper part.

* As for the position, place the back of the rice mat on the RICE POSITION ↘ marker.

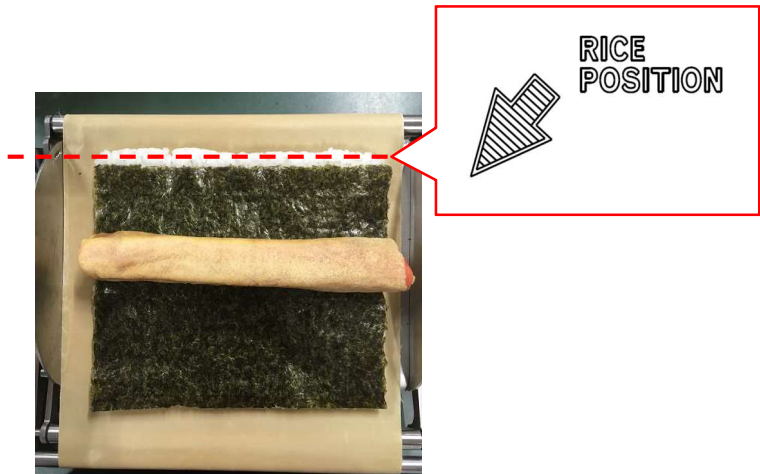

(2) Roll the rice mat and dried laver seaweed on the front over the ingredients.



(3) Fully pull the **Handle** and hold it in place for about 3 seconds.

* Do not pull down the **Handle** excessively. Doing so may cause the main unit to roll over and damage it.

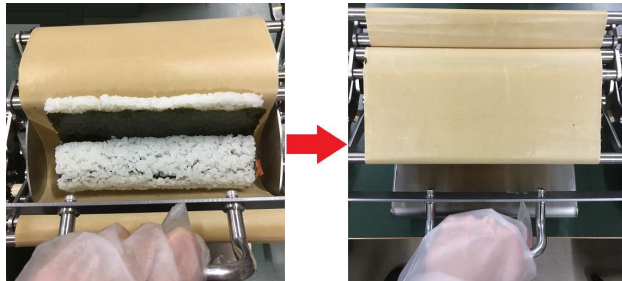

(4) Gradually return the **Handle** to its original position and remove the completed norimaki.



* Image after cutting the completed norimaki

Troubleshooting Checklist

Problem	Item to Check	Troubleshooting Procedure	Reference Page
The Handle does not move (or it does not move smoothly).	Is there anything caught between the gears?	Remove whatever has gotten caught and apply grease if necessary.	11 - 12
	Is the Belt properly set?	Set the Belt properly.	8 - 9
	Does the Safety Cover have any deformation?	Replace the Safety Cover with a new one.	-
	Is there any wear on parts in the mechanical section?	Replace with new part(s).	12
Norimaki are not formed properly.	Is the Belt properly attached?	Set the Belt properly.	8 - 9
	Are there any stains on the Belt ?	Wash the Belt according to the procedure.	12
	Is the Belt getting old?	Replace the Belt with a new one.	12

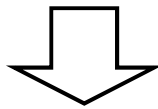

Is something still wrong?

If the above troubleshooting fails to solve the problem, contact the retail store where the machine was purchased.

Recommended Inspections

Inspect the machine when using it for a long period!

Check the following items.

- Is there any abnormal noise from the main unit when using the machine?
- Is the **Handle** unstable?
- Is the **Handle** extremely heavy or difficult to move?
- Is the **Belt** getting old?



Request

Stop using the machine to prevent any accident or failure. Contact the retail store where the machine was purchased.

Warranty & Repairs

1. Please complete the attached “Owner Registration Card” and mail it to us. You will be registered as an eligible user for the warranted service and repair, and the information you provide will be stored in our database.
2. If the machine fails to function properly or breaks down within the warranty period despite proper operation as indicated in this manual and the labels on the unit, bring the machine along with the Warranty Certificate to your retail store where you purchased this product for free repair.
3. This warranty is transferable to a new owner. The new owner continues to be protected until expiration of the original purchaser’s warranty period. If the appliance is moved to a new location, the warranty coverage continues. Any damage caused in transit to a new location, however, is not warranted.
4. For further information regarding repairs and after-care services, please contact your retail store or our Service Center.
5. In the following cases, repair charges will be incurred:
 - 1) Improper use; failure or damage due to unauthorized repair, alternation or modification
 - 2) Failure or damage due to dropping or improper transportation after sales
 - 3) “Owner Registration Card” has not been received by us or required information has not been provided.
 - 4) Failure or damage due to fire, earthquake, storm/flood, lightning, abnormal voltage or other natural phenomena
 - 5) Wear & tear (Teflon-coated parts, etc.)
 - * Teflon-coated parts are consumable parts. Re-coating or replacing these parts is subject to charge even during the warranty period.
6. This warranty is valid in U.S.A. Canada and Mexico Contact us for usage in other countries.
7. Please notify us if there is any change of your registered information such as address and owner name.
8. If the services are not available locally, please contact our Service Center.
9. For on-the-spot services, actual traveling expenses will be incurred.
10. For repairs after the warranty period, service charges will be incurred.

Product Specifications

Product Name	Norimaki Maker for Commercial Use
Shortened Name	MAKI MAKER
Product No.	ASA190A
External Dimensions	W 12.3 in. × D 13.3 in. × H 10.4 in. (313 mm × D 339 mm × H 265 mm) max. D 14.8 in. (376 mm) × H 12.8 in. (325 mm)
Mass	Approx. 15.4 lbs. (7 kg.)
Belt Width	9.1 in. (230 mm)
Rice Mat Length	Max. approx. 8.2 in. (205 mm)
Rice Mat Width	Max. approx. 8.2 in. (205 mm)
Norimaki Diameter	Approx. ϕ 0.8 in. – ϕ 2.4 in. (ϕ 20 mm) – (ϕ 60 mm)
Accessories	Push Shaft x 2, Belt x 1, Safety Cover x 2

External Diagrams

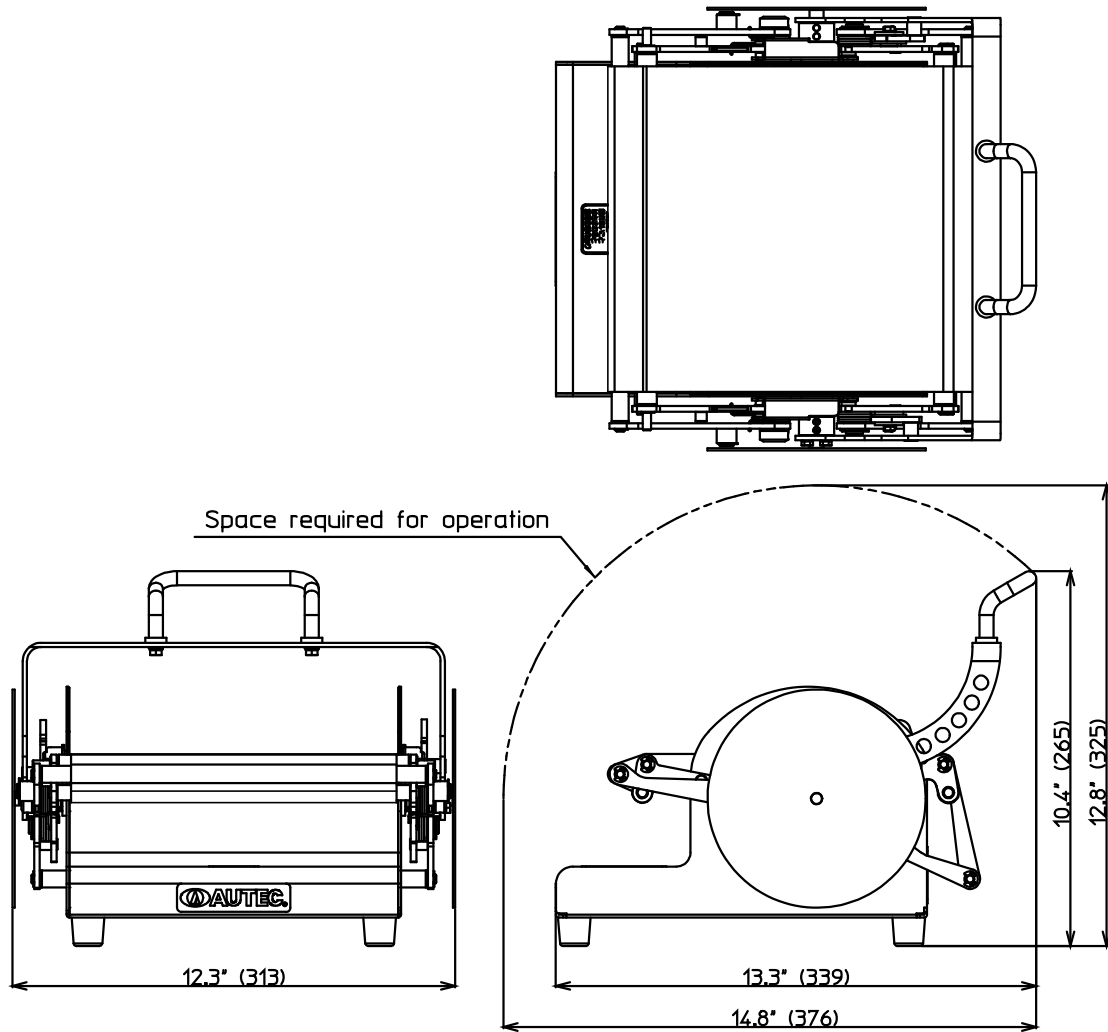

- The specifications and design of the machine may change without prior notice in order to improve performance.

<MEMO>

<MEMO>



AUTECH Inc.

Address: 3882 Del Amo Blvd. # 602 Torrance, CA 90503 U.S.A.

TEL : (310) 370-1680

FAX : (310) 370-1690

e-mail : sales@autecusa.com

URL : <http://www.sushimachines.com>